

Stamp

Material required:

- Foam rubber
- Cutter
- Scissors
- Thin plywood panels
- Small wooden block
- BLANCOL special adhesive FLEX
- BLANCOL glue gun



1. Draw a motif of your choice on the foam rubber and then cut it out.
2. Stick the motif to the wood panel using BLANCOL special adhesive FLEX, press down firmly and leave to dry.

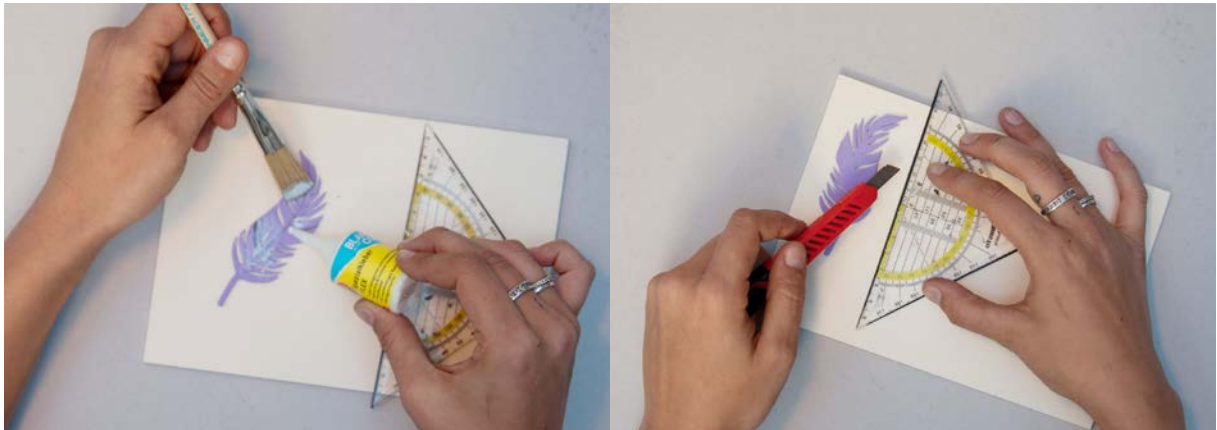

3. Now fix the small wooden block onto the back of your stamp using the BLANCOL glue gun.



4. You can start using the stamp as soon as everything is dry.

Tip: You do not need any special stamp pad to use the stamp. A normal watercolour or other paint that you can apply to your stamp motif with a paintbrush is also sufficient.

