

Food

Material required:

- Felt
- Foam rubber
- Polystyrene
- Pencil
- Scissors
- Cutter
- BLANCOL glue gun KIDS
- BLANCOL special adhesive STYRO



1. Draw the shape of the toast onto your felt twice and once onto a piece of polystyrene. Then carefully cut out the outlines. Tip: We recommend using a cutter to cut polystyrene.

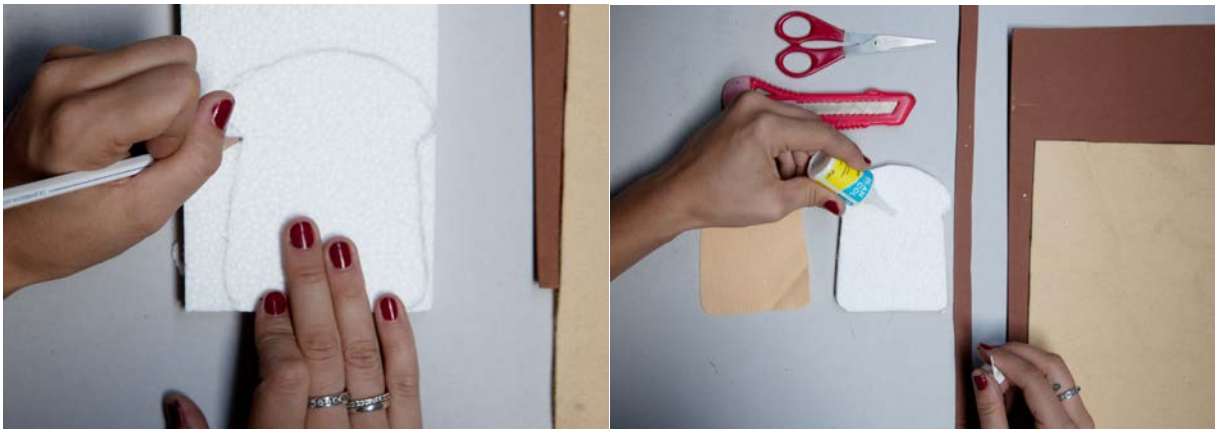

2. For the toast crust, cut out a piece of dark brown foam rubber that has the width of the piece of polystyrene. Please ensure that the foam rubber is as long as possible so that it extends around the toast in one piece.



3. First stick the two felt pieces to one side each of your polystyrene shape, using BLANCOL special adhesive STYRO, and press them down firmly. Then stick the long piece of foam rubber along its edge, using BLANCOL glue gun KIDS. If the foam rubber should be longer than the edge, this can simply be cut off when you are finished. Your toast is finished.

